

# INSTALLATION INSTRUCTION

**WKDPL39DCCDD-EE**  
(2000/06)

WATER EFFICIENT TAPWARE  
(NOMINAL FLOW RATE = 7.5 L/min)

## Pressure & Temperature Requirement

- \*Hot and cold water inlet pressures should be equal
- \*Inlet pressure range : 150 ~ 1000 kPa
- \*Maximum hot water temperature : 80 °C

## Important Notice Of Routine Maintenance And Care

- Occasional cleaning of aerator is recommended.
- Use of soapy water and a soft sponge or cloth is recommended.
- Avoid cleaning with chemicals, solvents, or harsh detergents. (THIS MAY SERIOUSLY HARM SURFACE AREA)
- If used with hard water or water with very high mineral content, it is absolutely necessary to clean and dry the tapware immediately after every use. (CALCIUM AND OTHER MINERALS COULD SERIOUSLY DAMAGE SURFACE AREA)
- Please wipe the canopy and keep your hands dry before installing or replacing the battery of the LED to prevent the LED circuit board from water or moisture damage.
- When installing with filtration system with carbon filters or changing carbon filters, it's suggested to flush the filtered tubes from the system before connecting with the tapware to prevent possible carbon dust contamination into tapware cartridge to cause leaking.

## Battery Installation Steps

### 1 Install Battery.

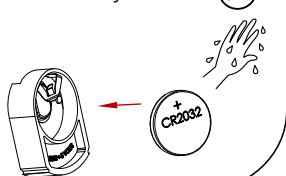

### 2 Reset: When installing or replacing battery, it will flash red light and follow by the blue light.

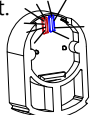

### 3 Install into tapware canopy. The slotted end must be oriented toward the tapware.

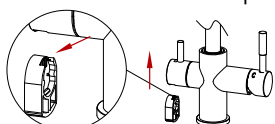

### 4 Blue light will flash when turning on the filtered water.

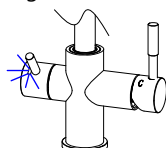

## LED Indicator

1. Blue light will flash at operation after the battery is installed. It will flash red light when it has been activated over 6 months or the actual operation time has exceeded 2000 minutes.
2. When it flashes red light, please change your filter and battery at the same time.

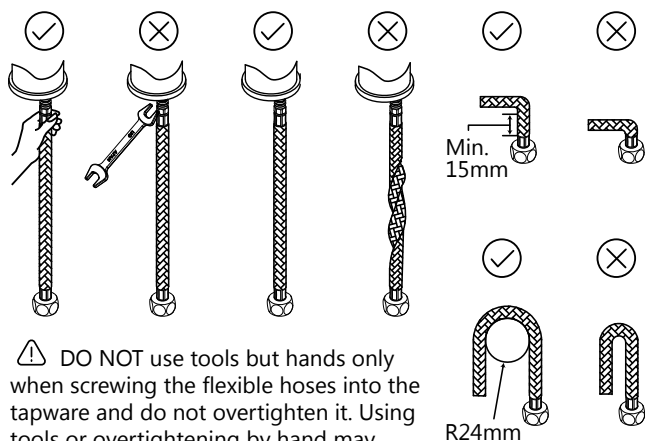

⚠ DO NOT use tools but hands only when screwing the flexible hoses into the tapware and do not overtighten it. Using tools or overtightening by hand may damage the tapware.

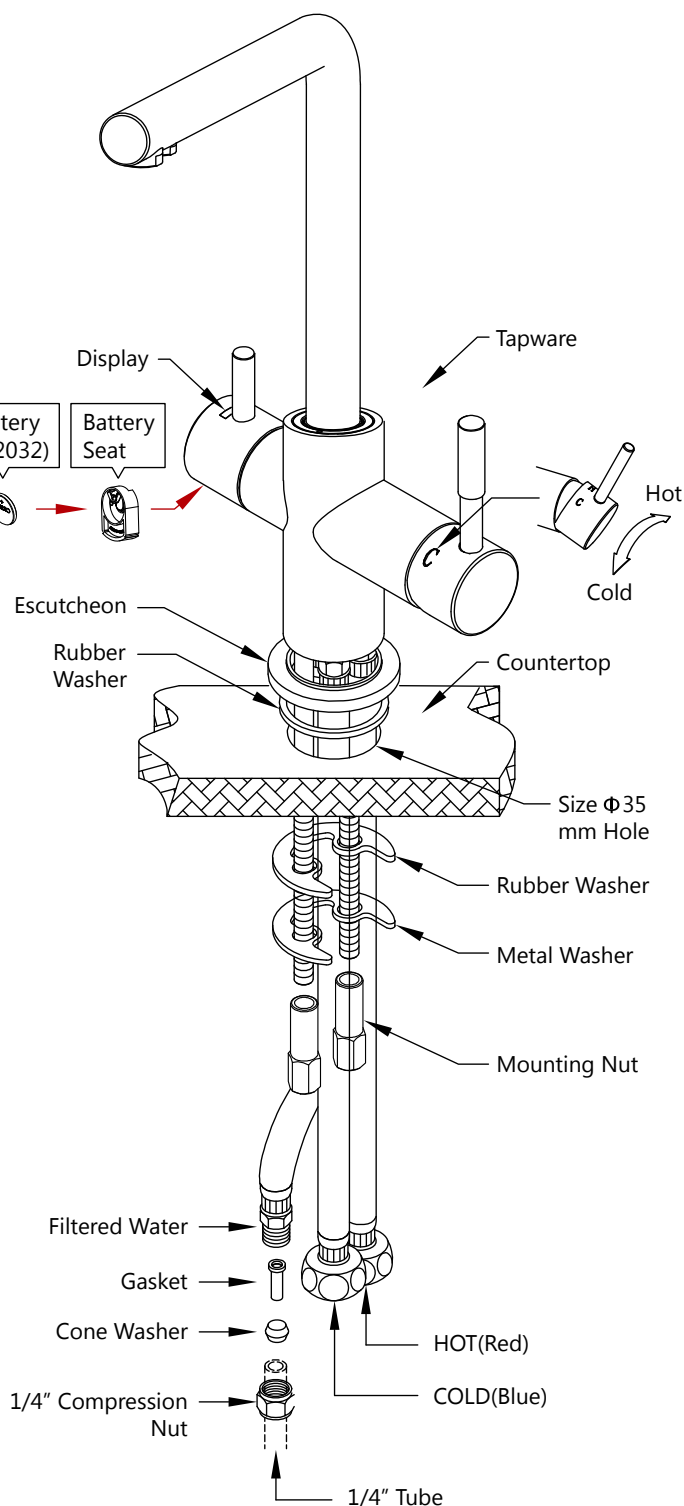

## Bottom View

